

MARS T1000

1000FT FULL-DUPLEX INTERCOM SYSTEM
1 PORTABLE BASE STATION WITH 4 BELTPACKS



1000FT
Transmission Range



Full-Duplex Wireless
Communication



Carrier-Grade
Voice Quality



Built-In Battery
(Beltpacks)



USB
Upgrade



Supports Daisy-
Chain Expansion



Supports
External Tally



OLED
Screen

APPLICATIONS

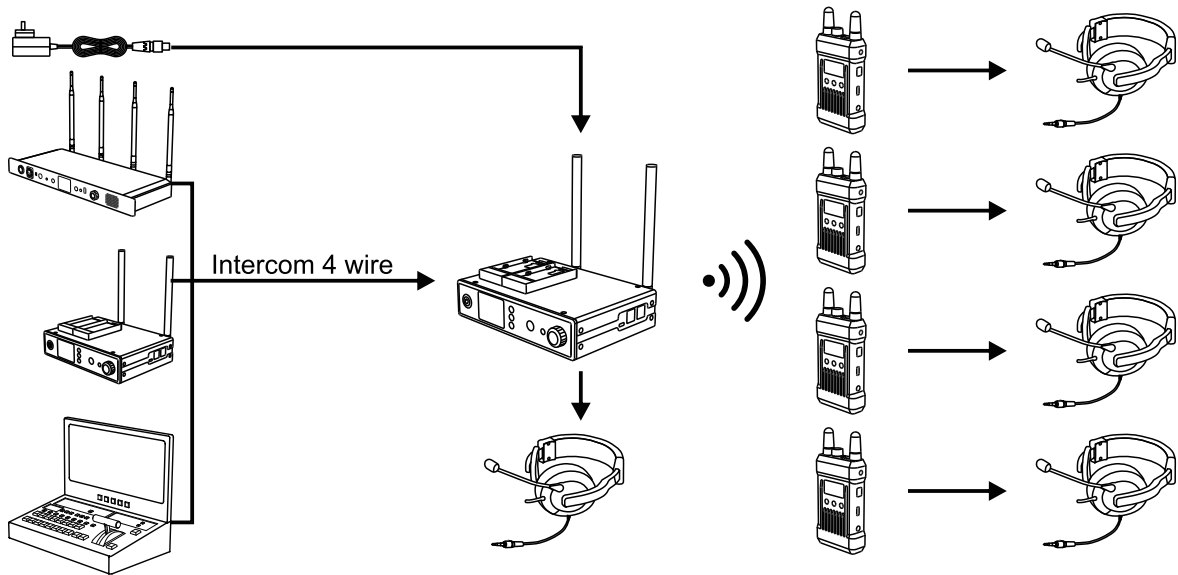

FEATURES

- 1000ft Working Range
- Carrier-Grade Voice Quality
- Full-Duplex Wireless Communication
- Provide More than 8 Hours of Battery Life
- 1 Base Station with 4 Beltpacks , Support Cascade Expansion

| | Base Station | Beltpack |
|-----------------------|--|---------------------------------|
| Power Supply Way | 7~36V DC Input;F970 Battery; POE supply(IEEE802.3af) | 1600mAh Polymer Lithium Battery |
| Frequency Response | 300Hz to 5KHz | |
| Signal-to-noise Ratio | >50dB | |
| Distortion | <2 % | |
| Working Range | Under LOS,1000ft working range from Base Station to Beltpack | |
| Frequency Band | 1.9GHz/2.4GHz | |
| Modulation Mode | GFSK | |
| Transmit Power | Maximum 24dBm | |
| Receiver Sensitivity | ≤ -93dBm | |
| Bandwidth | 1.728MHz | |
| Power Consumption | <6W | <0.7W |
| Temperature Range | 0~40°C(Operation condition); -20~60°C(Storage Mode) | |
| Certification | FCC; CE. | |

PACKING LIST

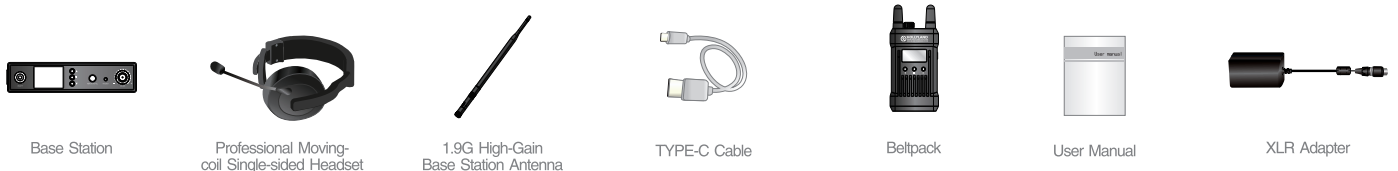

*Please subject to actual shipment as the standard if any difference in accessories.