

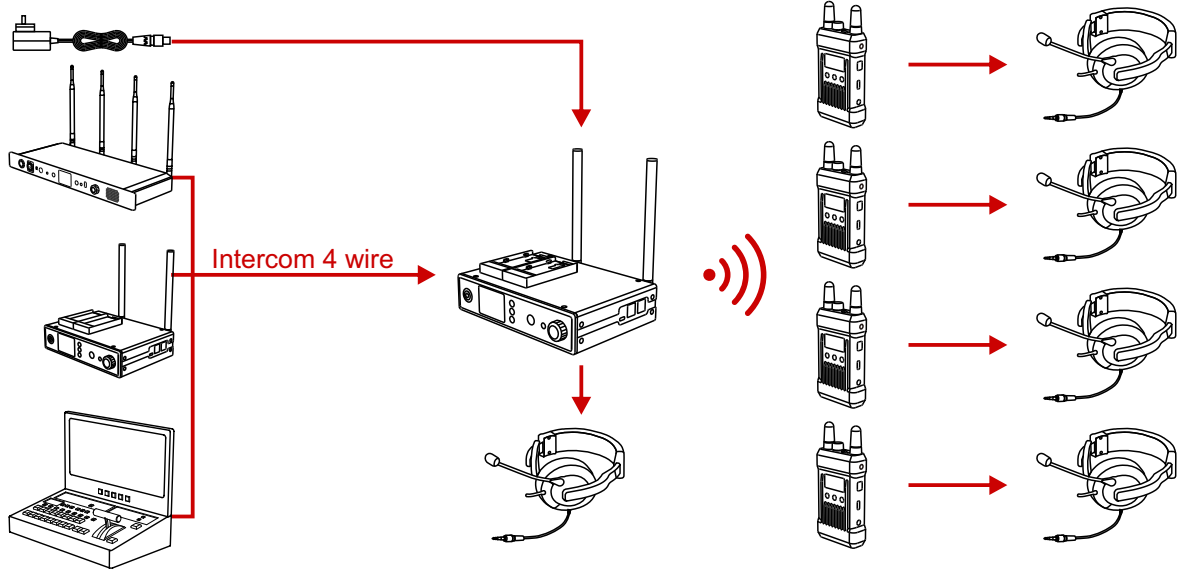

MARS T1000

1000FT FULL-DUPLEX INTERCOM SYSTEM
1 PORTABLE BASE STATION WITH 4 BELTPACKS

Applications



Features

- 1000ft Working Range
- Carrier-Grade Voice Quality
- Full-Duplex Wireless Communication
- Provide More than 8 Hours of Battery Life
- 1 Base Station with 4 Beltpacks, Support Cascade Expansion

	Base Station	Beltpack
Power Supply Way	7-36V DC Input;F970 Battery; POE supply(IEEE802.3at)	1600mAh Polymer Lithium Battery
Frequency Response	300Hz to 5KHz	
Signal-to-noise Ratio	>50dB	
Distortion	<2 %	
Working Range	Under LOS,1000ft working range from Base Station to Beltpack	
Frequency Band	1.9GHz	
Modulation Mode	GFSK	
Transmit Power	Maximum 24dBm	
Receiver Sensitivity	≤ -93dBm	
Bandwidth	1.728MHz	
Power Consumption	<6W	<0.7W
Temperature Range	0-40°C(Operation condition); -20-60°C(Storage Mode)	
Certification	FCC; CE.	

Packing List

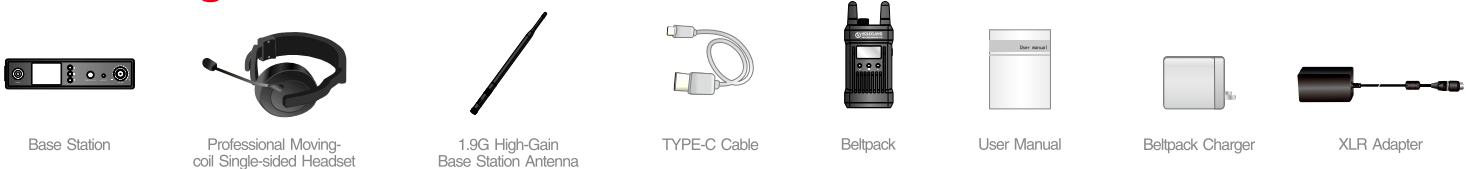

*Please subject to actual shipment as the standard if any difference in accessories.